

Small-Sized Compression Load Cells

21 mm dia., 10 mm thick

LMR-S-SA2

2 to 20 kN

Compact

Lightweight

Affordable prices

Suitable for load distribution measurement

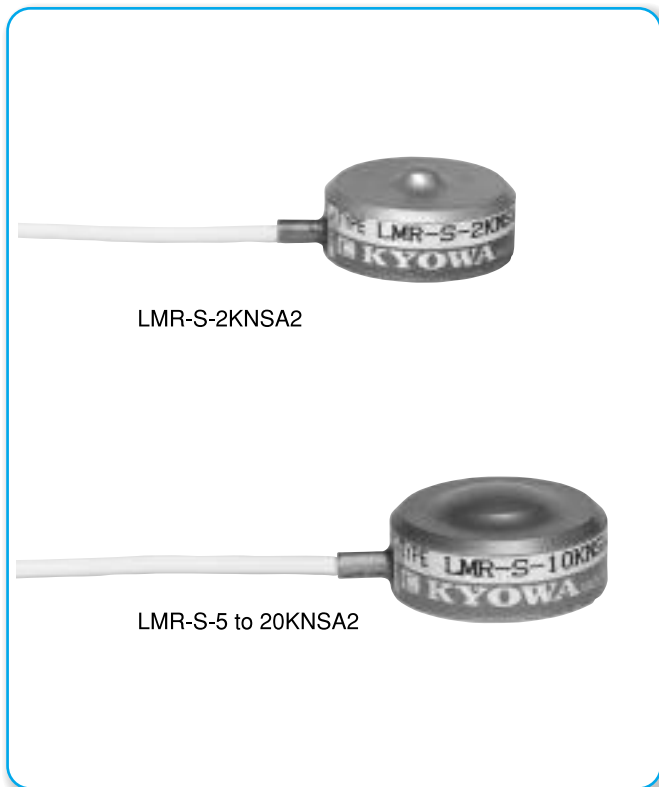

Compact and lightweight load cells in the LMR-S-SA2 series can be used by merely putting or bonding on the subject site or setting in a hollow. Major applications include measurement of load distribution by using multiple units and measurement of the load applied in making pipes or where a measuring site or the mass of load cell itself is limited.

Specifications

Performance	
Rated Capacity	See table below.
Nonlinearity	Within $\pm 1\%$ RO (20KNSA2: Within $\pm 2\%$ RO)
Hysteresis	Within $\pm 1\%$ RO (20KNSA2: Within $\pm 2\%$ RO)
Repeatability	1% RO or less
Rated Output	1 mV/V (2000 $\mu\text{m/m}$) or more
Environmental Capability	
Safe Temp. Range	-10 to 60°C
Comp. Temp. Range	0 to 50°C
Temp. Effect on Zero Bal.	Within $\pm 0.05\%$ RO/ $^\circ\text{C}$
Temp. Effect on Out.	Within $\pm 0.05\%$ / $^\circ\text{C}$
Electrical Characteristics	
Safe Excit. Voltage	7 V AC or DC
Recom. Excit. Voltage	1 to 2 V AC or DC
Input Resistance	$350 \Omega \pm 2\%$
Output Resistance	$350 \Omega \pm 2\%$
Cable	4-conductor (0.035 mm ²) heat-resistant vinyl shielded cable 1.7 mm diameter by 2 m long, bared at the tip (Shield wire is not connected to the mainframe.)
Mechanical Properties	
Safe Overload Rating	120%
Natural Frequency	See table below.
Weight	See table below.
Protection Rating	IP 64 (Sprashproof type conforming to JIS C 0920)
Enclosure	Stainless steel

Model	Rated Capacity	Nat. Freq. (App.)	Weight (App.)
LMR-S-2KNSA2	2 kN	50 kHz	25 g
LMR-S-5KNSA2	5 kN		
LMR-S-10KNSA2	10 kN		
LMR-S-20KNSA2	20 kN		

Users should be cautioned that operating conditions may adversely affect the stated specifications.

Dimensions

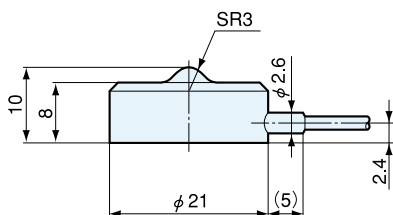

LMR-S-2KNSA2

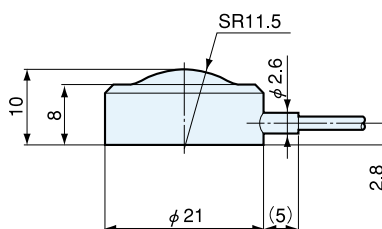

LMR-S-5 to 20KNSA2